

# APPLICATION DETAILS - NEW CONSTRUCTION SECTION VIEWS



## STONEDEKS / SILCA SYSTEM

356 EAST MARYLAND AVENUE. SEBRING, OHIO 44672

PHONE: (330) 821-1585

[www.stonedeks.com](http://www.stonedeks.com)

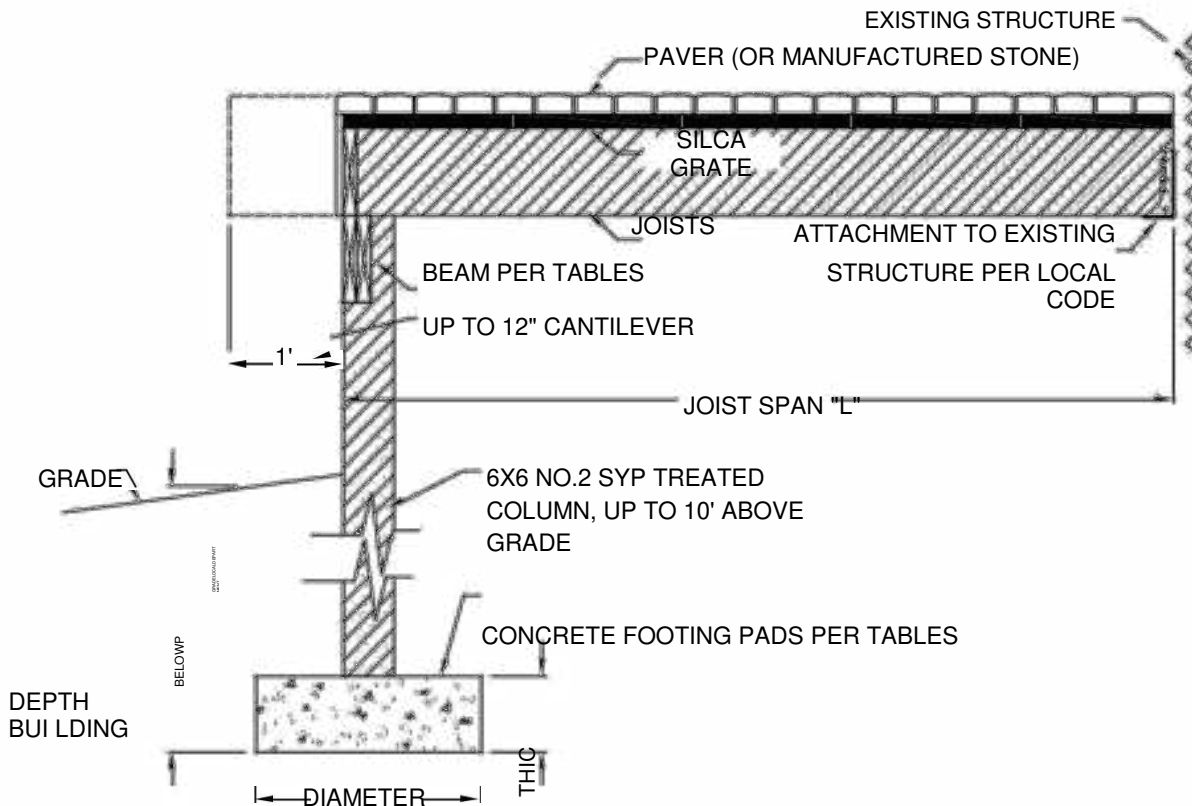

### NEW CONSTRUCTION SECTION

MAXIMUM JOIST SPANS "L" - WHEN USING PAVERS 3/4" TO 3" THICKNESS

JOIST SIZE	NATURAL STONE OR MANUFACTURED CONCRETE PAVER THICKNESS				
	3/4"	1 1/4"	2"	2 1/2"	3"
2X6	8'-9"	8'-5"	7'-10"	7'-5"	7'-2"
2X8	11'-4"	10'-9"	10'-0"	9'-6"	9'-2"
2X10	13'-7"	12'-10"	11'-11"	11'-4"	10'-11"
2X12	16'-0"	15'-2"	14'-1"	13'-4"	12'-10"

**NOTES:**

1. INSTALLATION TO BE COMPLETED IN ACCORDANCE WITH MANUFACTURER'S SPECIFICATIONS.
2. DO NOT SCALE DRAWING.
3. THIS DRAWING IS INTENDED FOR USE BY ARCHITECTS, ENGINEERS, CONTRACTORS, CONSULTANTS AND DESIGN PROFESSIONALS FOR PLANNING PURPOSES ONLY. THIS DRAWING MAY NOT BE USED FOR CONSTRUCTION.
4. FOR PRODUCT AND COMPANY INFORMATION VISIT [WWW.STONEDEKS.COM](http://WWW.STONEDEKS.COM) OR CALL 330-821-1585.